

BERT FRANK

COLT DOUBLE WALL LIGHT

MAINTENANCE

- Lacquered brass should be wiped with a soft duster.
- Do not clean with any liquid, chemical or abrasive cleaners.
- All electrical work must be conducted by a qualified electrician.

TECHNICAL

- 2x LED module = 15.6W 24V 2700K
- 2x INTEGRATED driver = 20W 24V constant voltage

www.berfrank.co.uk
+44 (0)207 164 6482

INSTRUCTION

- 1
- Feed mains power through mounting plate and attach plate to wall using suitable fixings.
 - Ensure mounting plate is attached straight.

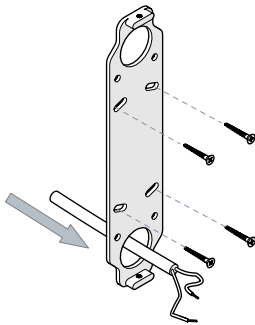

- 2
- Make electrical connection.
 - Connector block not supplied. Fixings not supplied.
 - Electrical work must be conducted by a qualified electrician.

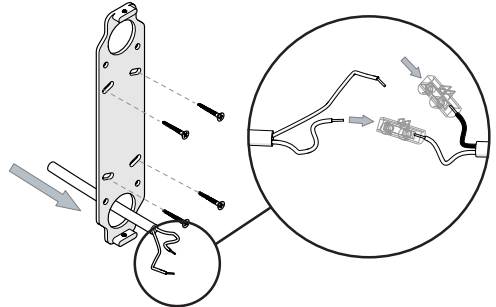

- 3
- Position fixture over mounting plate and secure using 2x screws in top/bottom of wall cover.

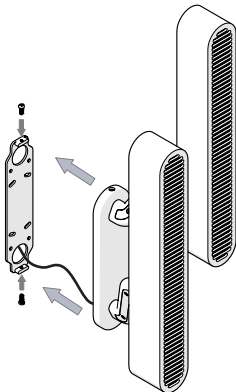

4

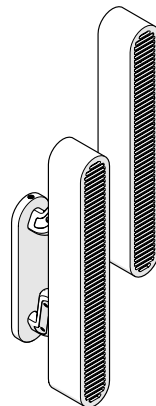

LED 'BULB' REPLACEMENT INSTRUCTION

- 1
- Remove 2x screws from top and bottom of backside of fixture
 - Carefully slide brass shade off assembly to expose LED module.

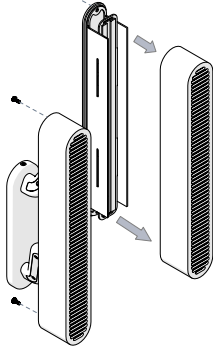

- 2
- Pull back both sides of LED bracket slightly to release LED plate.
 - Remove LED plate from bracket

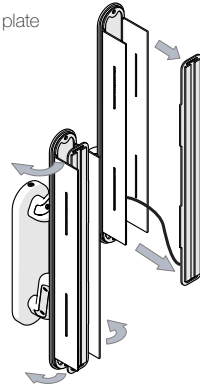

- 3
- Release electrical connector and disconnect LED plate.
 - Connect replacement LED plate to electrical connector and insert LED plate back into LED bracket.
 - Ensure side with double LED strip is facing out.

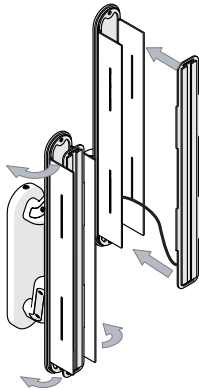

- 4
- Replace brass shade and secure using 2x screws.

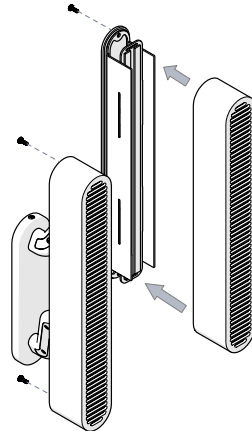

This product is only suitable for connection to the native power supply to which the unit was specifically manufactured. It is for indoor use only, and not suitable for a bathroom location.

If the Class II, double insulated symbol is on the lamp, it does not require an Earth, and Live or Neutral must not be connected to Earth. If there is no such symbol, then the lamp must be Earthed.

Under no circumstances must this lamp be covered with any material as this could pose a safety hazard. It must be used on a stable, flat surface.

Never fit bulbs of a higher wattage than those specified on the label, as these may cause overheating and damage the fitting. If the mains cable becomes damaged it must only be replaced by a technically competent, qualified person.

Allow 10 minutes to cool before replacing, adjusting or cleaning. Clean with a dry cloth only. Do not use liquid or abrasive cleaners on this product.

If you are in any doubt about your competence please consult a qualified electrician. If any modification is made it will invalidate the warranty and may render the product unsafe.